



PROFILESERIES
PSU10, PSU15, PSU23, PSU30
PSU40

Installation
Operating
Maintenance

Pleasereadtheseinstructions thoroughly beforebeginning yourinstallation!

The Profile series fan convectors are designed for installation in a forced hot water (hydronic) heating system. They may also be used with conventional gas, oil, electric or solar powered water heaters.

IMPORTANT: BEFORE INSTALLING ANY HEATING TERMINAL UNIT TO A DOMESTIC WATER HEATER, CONSULT YOUR LOCAL PLUMBING CODES.

When installing fan convectors, an accurate heat loss calculation of the space is required. Match unit selection with BTUH output at system water temperature and flow rate. See the capacity chart below for output at various water temperatures and flow rates.

PERFORMANCE&SPECIFICATIONS

Capacities for the Profile fan convectors – BTU/hr @ 65°F Entering air

| Model | Fan Speed | Pres.D rop-ft | 130° | 140° | 150° | 160° | 170° | 180° | 190° | 200° | 210° |
|-------|-----------|---------------|-------|-------|-------|-------|-------|-------|-------|-------|-------|
| | PSU10 | MAX | 2.75 | 3307 | 4278 | 5325 | 6192 | 7024 | 7957 | 9081 | 9736 |
| MIN | | 2315 | | 2994 | 3727 | 4334 | 4915 | 5570 | 6350 | 6810 | 7415 |
| PSU15 | MAX | 3.07 | 3983 | 5120 | 6255 | 7382 | 8933 | 10590 | 12250 | 14349 | 15430 |
| | MIN | | 2788 | 3580 | 4375 | 5163 | 6250 | 7412 | 8575 | 10040 | 10800 |
| PSU23 | MAX | 3.82 | 6645 | 8790 | 10932 | 13070 | 15210 | 17370 | 19500 | 21530 | 23820 |
| | MIN | | 4650 | 6150 | 7651 | 9145 | 10645 | 12160 | 13645 | 15072 | 16675 |
| PSU30 | MAX | 4.6 | 7550 | 10050 | 12750 | 15800 | 19150 | 22000 | 24900 | 27750 | 30450 |
| | MIN | | 5300 | 7030 | 8900 | 11020 | 13380 | 15350 | 17400 | 19425 | 21310 |
| PSU40 | MAX | 4.6 | 16500 | 19720 | 21384 | 23166 | 25300 | 29402 | 31600 | 35640 | 40700 |
| | MIN | | 14204 | 17000 | 18250 | 20050 | 23008 | 25200 | 27055 | 29184 | 31040 |

Entering Water Temperature in degrees F – BTU/hr

1. Capacities for the PSU10, 15, 23 are based on 2 gpm. Correction factors for: .5 gpm = .80; 1.5 gpm = .96; 2.5 gpm = 1.07; 3.0 gpm = 1.12 and 5 gpm = 1.23.
2. Capacities for the PSU30 and PSU40 are based on 3 gpm. Correction factors for: 1.0 gpm = .85; 5 gpm = 1.18.

Note: All Smith’s fan convectors include a low limit aquastat which shuts off power to the fan when water temperature falls to 90°F. Power is restored when water temperature rises to 110°F.

Unit Inspection

Before starting the installation, carefully remove the fan convector from its box. Inspect for any damage that may have been caused in handling.

Locating the fan convector

Profile series fan convectors are designed to give high BTUH capacities from a small cabinet. They should be installed as near to the area of greatest heat loss as possible. The removable skirt enables mounting flush to the floor or above the baseboard. Ensure adequate space to remove the cover for service and installation. Access to piping and electrical connections are through the back OR bottom of the unit.

Preparing the site

Take off the outer cover by first removing the screws located on each side, then gently lifting the casing upward and away from the chassis. Determine the exact location of the unit and place the chassis against the wall. Mark the locations of the piping and electrical cutouts.

Note: The piping and electrical connections may be made through the back OR bottom of the unit.

Set the chassis aside and prepare piping and electrical accordingly. To remove the bottom skirt, turn the chassis over and take out screws located in the underside.

Installing the fan convector

Profile fan convectors are equipped with the E-Z hanger mounting strip to make installation simpler. Make a straight level line on the wall per the diagram below. Center the E-Z hanger strip on the line and secure with the screws provided.

Note: Make sure that the E-Z hanger strip is level. Mount the chassis by engaging the slots in the rear onto the E-Z hanger strip. Screw the bottom of the unit into the wall through the holes provided.

| Model | A | B | C | D |
|-------|-------|-------|------|------|
| PSU10 | 12.03 | 6.25 | 5.50 | 5.00 |
| PSU15 | 12.03 | 21.75 | 3.87 | 3.37 |
| PSU23 | 12.03 | 21.75 | 9.50 | 8.87 |
| PSU30 | 19.19 | 21.50 | 4.75 | 4.25 |
| PSU40 | 19.19 | 21.75 | 9.0 | 9.0 |

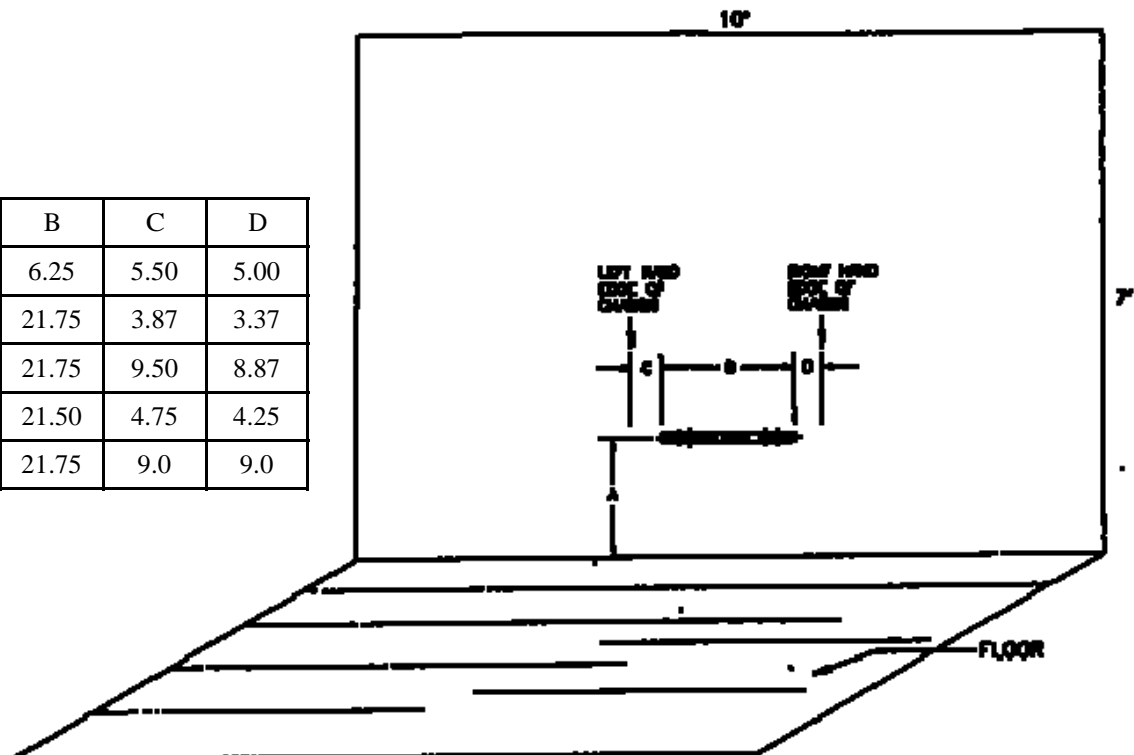

Make sure the fan convector is level and secure to the wall.

Piping

Water supply and return connections are 1/2" copper tube for the PSU10, 15, 23 and 3/4" for the PSU30 and 40. The water supply is fed at the bottom connection and the return is the top connection (with the built-in bleeder air vent). Check to see that both soldered connections are leak free.

Note: Isolation valves are recommended on both supply and return piping to allow for service and balancing if necessary.

After filling the fan convactor with water, it will be necessary to remove the air from it. A built in bleeder air vent is located on the return pipe at the top left of the unit. This vent may be operated with a screwdriver. Be careful as some water may be bled along with air. Since air accumulates at the high points of a system, it may be necessary to repeat this step after initial operation.

See diagrams for recommended piping diagrams.

ElectricalConnections

ALL ELECTRICAL CONNECTIONS MUST COMPLY WITH LOCAL OR NATIONAL REGULATIONS. IF IN DOUBT, CONSULT A QUALIFIED ELECTRICIAN.

Smith's Profile fan convectors are UL approved.

Remove the electrical junction box cover through the screw provided. There are two knockouts in the back and side of the junction box. Select the most convenient and bring wiring through it. Supply conductors should be 14 AWG and protected by a 15 AMP over current protector. Connect line input to black lead, neutral to white lead and ground to pillar marked G inside the junction box. Refer to diagram below for complete wiring instructions.

Operation

Before replacing the outer cover, ensure that the fan convector is operating properly. Activate the system thermostat and place speed switch in position I. Because of the low limit aquastat, it may be several minutes before the fan comes on. When it does come on, make sure that the switch is operational by moving to Off then II. Best results are obtained by leaving the switch in position I and reserving II for quick heat up or extreme conditions. If the unit is not operating, see the troubleshooting tips at the end of the manual.

Unitmaintenance

The Profile series fan convectors are designed for years of trouble free operation with very little maintenance. It is recommended however, that the unit be vacuumed occasionally through the front grille. This is especially important in areas with lots of dust, pet hair and dirt.

If servicing is required beyond this, contact the installing contractor or

Smith's Environmental Products
Customer Service
300 Pond St
Randolph, MA 02368
(781) 986 – 2525

TroubleshootingTips

If the fan convector does not operate:

- ⇒ Verify that supply voltage is 120 VAC, all wires are connected and fan switch is in Min or Max position.
- ⇒ Verify that hot water is going to and through the unit at 130°F or above. Both supply and return pipes should be hot. An air bound coil will prevent the fan from operating. Bleed air from the coil if necessary.
- ⇒ By pass the low limit aquastat using a jumper wire. If the fan now runs, replace the aquastat.
- ⇒ If the fan does not run while the aquastat is jumped, replace the motor assembly.

Diagram of model and part numbers

| Item | Description | PSU10 | PSU15 | PSU23 | PSU30 | PSU40 |
|---------|-------------------------------|-----------|-----------|------------|------------|------------|
| 1 & 3 | Fan motor (single) & Assembly | S10029 | NA | S10029 | S10029 | S10029 |
| 1A & 3A | Fan motor (double) & Assembly | NA | S06-0006 | S06-0006 | S06-0006 | S06-0006 |
| 2 | Outboard bearing | S10010 | S10010 | S10010 (3) | S10010 (3) | S10010 (3) |
| 4 | Rocker switch | S10051 | S10051 | S10051 | S10051 | S10051 |
| 5 | Coil | S10052/53 | S10052/53 | S10054 | S10107 | S02-0006 |
| 6 | LTCO 110-130° Optional | S10028 | S10028 | S10028 | S10028 | S10028 |
| 6A | LTCO 90-110° Standard | S10046 | S10046 | S10046 | S10046 | S10046 |

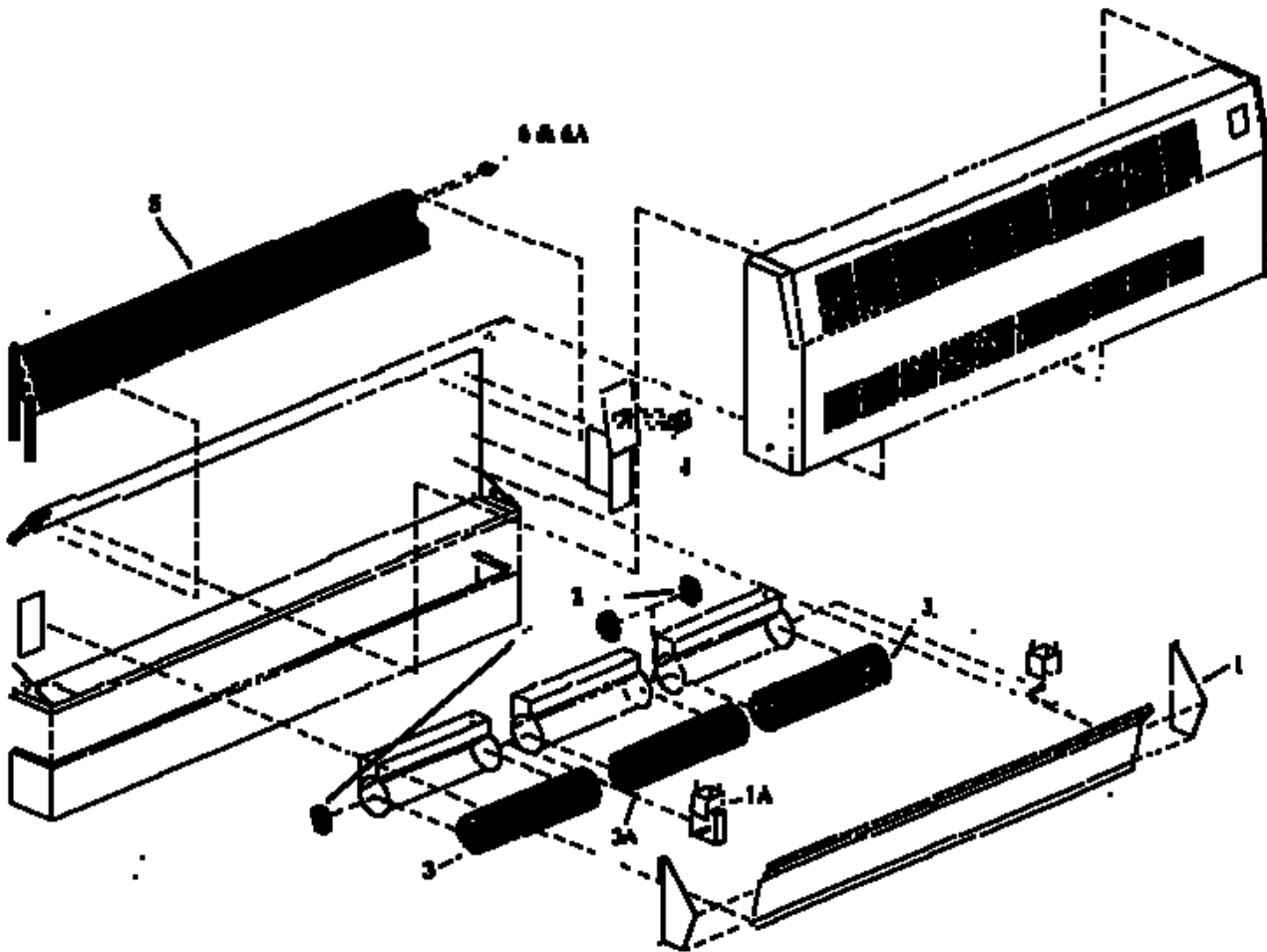



LIMITED WARRANTY

The Smith's Environmental Products Limited Warranty

Smith's Environmental Products warrants the original purchaser that products manufactured and/or supplied by them will be free from defects in materials and workmanship under normal conditions of use, when properly installed and maintained in accordance with Smith's instructions for a period of 60 months from date of shipment, or 54 months from date of installation, whichever occurs first. During this warranty period, Smith's will, at its option, repair or replace any product, or part thereof, which shall be returned to the Smith's factory and determined by Smith's to be defective. There are no warranties, expressed or implied, that extend beyond this warranty description. In no event will Smith's be liable for labor or consequential damages.

EXCEPTIONS AND EXCLUSIONS

1. THIS WARRANTY IS SUBJECT TO THE CONDITION THAT THE SMITH'S PRODUCT MUST HAVE BEEN INSTALLED BY A HEATING CONTRACTOR WHOSE PRINCIPAL OCCUPATION IS THE SALE, INSTALLATION OR SERVICING OF PLUMBING, HEATING AND/OR AIR CONDITIONING EQUIPMENT.
2. This warranty does not cover expenses for removal or reinstallation. The homeowner will be responsible for the cost of removing and reinstalling the defective part or its replacement and all labor and material connected therewith. Replacement material will be invoiced to the distributor in the usual manner and will be subject to adjustment upon proof of defect. This warranty, in no way, can be considered as a guarantee of workmanship of an installer connected with the installation of the Smith's product or as imposing on Smith's liability of any nature for satisfactory performance as a result of faulty workmanship in the installation, which liability is expressly disclaimed.
3. This warranty will not be applicable if the Smith's product has been damaged as a result of being improperly serviced or operated.
4. In order for this warranty to be effective:
 - a. Smith's product must not have been damaged in handling during shipment or installation.
 - b. Smith's product must not have been removed from original installation site.
 - c. The model number and serial plates must not have been defaced or removed.
 - d. The controls/limit settings must be set in accordance with Smith's installation instructions, except those preset at factory.
 - e. Smith's product must be installed in accordance with local, state and national safety codes.
5. THE REMEDY FOR BREACH OF THIS WARRANTY IS EXPRESSLY LIMITED TO THE REPAIR OR REPLACEMENT OF ANY PART FOUND TO BE DEFECTIVE UNDER CONDITIONS OF NORMAL USE AND THE REMEDY FOR BREACH OF THIS WARRANTY OR FOR NEGLIGENCE DOES NOT EXTEND TO LIABILITY FOR INCIDENTAL, SPECIAL OR CONSEQUENTIAL DAMAGES OR LOSSES SUCH AS LOSS OF THE USE OF THE MATERIALS, INCONVENIENCE OR LOSS OF TIME. SOME STATES DO NOT ALLOW THE EXCLUSION OR LIMITATION IF INCIDENTAL OR CONSEQUENTIAL DAMAGES, SO THE ABOVE LIMITATION OR EXCLUSION MAY NOT APPLY TO YOU.
6. THIS WARRANTY IS IN LIEU OF ALL OTHERS, AND ANY AND ALL EXPRESS OR IMPLIED WARRANTIES (INCLUDING WITHOUT LIMITATION, ANY IMPLIED WARRANTIES OF MERCHANTABILITY OR FITNESS FOR A PARTICULAR PURPOSE) ARE EXPRESSLY LIMITED IN DURATION TO THE PERIOD OF THE WARRANTY AS PREVIOUSLY STATED HEREIN. SOME STATES DO NOT ALLOW LIMITATIONS ON HOW LONG AN IMPLIED WARRANTY LASTS, SO THE ABOVE LIMITATION MAY NOT APPLY TO YOU.

For prompt warranty service, notify the installer who, in turn, will notify the distributor from whom he purchased the Smith's product. If this action does not result in warranty service, contact Smith's with details in support of the warranty claim. Alleged defective part or parts must be returned through trade channels in accordance with the procedure currently in force for handling returned goods for the purpose of inspection to determine cause of failure. Smith's will furnish the new part(s) to an authorized distributor who, in turn will furnish the part(s) to the heating contractor who installed the Smith's product. If you have any questions about the coverage of this warranty, contact Smith's at the address below.

300 Pond St., Randolph, MA 02368 (781) 986-2525
Revised July 1, 2015



Unique Heating Solutions

From



Corporate Office
300 Pond St.
Randolph, MA 02368
(781) 986 -2525
Fax (781) 986-8934

Visit our website at: www.smithsenvironmental.com